



PETER JONES (ILG) LTD

Police & Security
Equipment



www.peterjonesilg.co.uk

VISIT OUR WEBSITE

PETER JONES (ILG) LTD

ILG Cases for TETRA Cases for DMR Police Equipment KLICK FAST

Industrial Leather Goods from Peter Jones (ILG) Ltd

If you carry it ...we protect it.

Here at Peter Jones (ILG) Ltd, we celebrated our 50th year of business in 2017, and reaching this milestone was only made achievable through our incredibly loyal customer base. The company remains a family business, with Peter's three children running the business since his retirement in 2003. If you would like to find out more about our history then please visit our history page.

Leather. No other material is quite like it... Durable yet flexible, tough yet comfortable. There's no doubt about it; when it comes to making the best performing carriage and protection systems, leather gives us the edge.

Leather

PETER JONES (ILG) LTD

Full adherence to ISO 9001: 2015 Quality System ensures that customer satisfaction is maintained.

Certified to ISO 14001: 2015 Environmental Standard, which helps us improve our environmental performance through more efficient use of resources and the reduction of waste.

Please contact our Sales Team with any enquiries.
E-mail: sales@peterjonesilg.co.uk
Telephone: 01873 852742
(N.B. International dialling code for the UK is +44)

But our experience goes far beyond leather. We combine traditional skills with modern materials and technology to provide tough, durable products for ever more demanding environments. We are an innovative company, producing new ideas and solving carry and protection problems for our customers. Manufacturing high quality industrial leather goods since 1967 means we have built up an unbeatable wealth of experience. We are manufacturers, not mere resellers, and all our holders are made in our own factory in the UK.

The past few years have seen record investment in new buildings, new equipment, further staff training and, of course, our dedication to customer satisfaction remains as strong as ever. Our design and prototyping service is widely regarded as the best in the industry and our in-house tooling facilities ensure that we can be first to market whenever new products are released.

Home Design History Klick Fast System Video Demos Privacy Policy Cookie Policy Terms & Conditions

Peter Jones (ILG) Ltd
Lower Monk Street, Abergavenny NP7 5LU
Telephone: +44 (0) 1873 852742
Email: sales@peterjonesilg.co.uk

Copyright Peter Jones (ILG) Ltd

Visit our website at peterjonesilg.co.uk where you will find details of a wide range of Peter Jones products to meet your carriage needs.



You can also watch **Video Demonstrations** of our main police and security focused products at peterjonesilg.co.uk/videos

COMPANY PROFILE

As a manufacturer of high quality industrial leather goods since 1967, Peter Jones (ILG) Limited combines traditional skills with modern materials and technology to provide tough, durable products for an ever demanding environment.

Investment in additional factory space, machinery and staff training will offer further manufacturing and service benefits to customers.

The Peter Jones (ILG) Ltd range of police and security equipment is constantly reviewed and updated. Innovative designs are based on the requirements of the relevant agencies with whom we liaise at each stage of development. In addition to standard uniform accessories we offer customised variations that satisfy personnel engaged in alternative duties.

Company Name	Peter Jones (ILG) Ltd
Contact Details	
Address	Lower Monk Street, Abergavenny, Monmouthshire NP7 5LU, UK
Telephone	UK 01873 852 742 Int'l+44 1873 852 742
Fax	UK 01873 857 573 Int'l+44 1873 857 573
Skype	peterjonesilg
E-mail (general)	sales@peterjonesilg.co.uk
Website	peterjonesilg.co.uk

Company Details

Established	1967
Employees	34
Policy	"Total commitment to provide quality products, an efficient service and, above all, customer satisfaction"
Specialist Products	Industrial Leather Goods (ILG) Supplementary Synthetic Products
Services and Skills	Design and Production Customisation Traditional Craftsmanship Modern Technology
Quality Certification	ISO 9001:2015
Environmental Certification	ISO 14001:2015
Markets Served	Police, Fire and Ambulance Services Prisons and Security Agencies Ministry of Defence Corporate and private organisations UK and worldwide

CONTENTS

INCAPACITANT SPRAY HOLDERS	4-5
TETRA AIRWAVE CASES	6
HANDCUFF HOLDERS	7
KLICK FAST SYSTEM	8-11
BELTS and ACCESSORIES	12-13
BATON HOLDERS	14-15
PRODUCT REFERENCE	16

Our Terms and Conditions are available at:
peterjonesilg.co.uk/company/TandC.pdf





P175SEW
Sew-on Holder



P175MV
Holder for use on MOLLE Vest



P175KF
For use with full range of KlickFast Docks (see page 10)

USE THE BENEFITS—GAIN THE ADVANTAGE

- ✓ Canister protection
- ✓ Lanyard security
- ✓ Right/left hand preference
- ✓ Ease and speed of withdrawal/relocation
- ✓ Positive hand grip
- ✓ Directional control
- ✓ Adjustable carriage
- ✓ Choice of spray type
- ✓ Choice of belt loop size
- ✓ Detachable for secure storage
- ✓ Withstands decontamination processes



P175CSTR
Motorcycle boot spray holder attachment



P175AR
Fixed position, Right hand use

P175AL
Fixed position, Left hand use



P175





P175



NON-LETHAL SPRAY HOLDER

P175

Made from high quality leather and durable nylon, the P175 provides essential **PROTECTION—SECURITY—DELIVERY** of canisters and non-lethal sprays

Designed and developed with the assistance of operational and training personnel, the P175 range of innovative spray holders addresses the failures and difficulties experienced with conventional pouches. Acknowledged by many police forces in the UK and overseas as one of the fastest, most effective means of delivering non-lethal sprays, the P175 ensures the advantage in the time of need.

For use with both OC or CS sprays using interchangeable pots to suit a choice of canister diameters and lengths.



P175POT35

Spray canister pot 35mmØ

P175POT38

Spray canister pot 38mmØ

P175POT38L

Spray canister long pot 38mmØ



P175KT

Kit form spray holder for riveting onto body armour

NYSTR67

Lanyard with split rings and clip

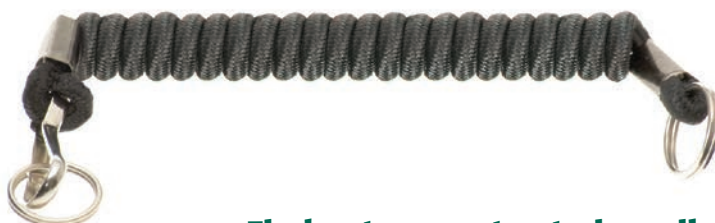

Find out more at peterjonesilg.co.uk/p175

TETRA AIRWAVE CASES

Cases shown fit 50mm Belt. (To fit 60mm Belt, add **D07** to part number.)

Sepura

SRPGPS
SRH3800
STP8000
STP9000



RSRHADJRS P1 KF



RSTPILGHDS P1 KF

more cases are available at peterjonesilg.co.uk/tetra-sepura

Motorola

MTH650
MTH800
MTP850



RMTP3250 P1 KF



RMTP3250 P2 KF

more cases are available at peterjonesilg.co.uk/tetra-motorola



RWBAG04 KFNOD

Waterproof bag for Sepura, Motorola and Airbus radios

Airbus

THR880
THR880i
THR9
THR9i



RTH1N P1 KF

RTHR9 P1 KF



more cases are available at peterjonesilg.co.uk/tetra-airbus

Smart Phones



SNOKIA930FUP1KF

Case for Nokia 930 range



RSTUDGALNOTE4FIT

Stud conversion for Otterbox Defender cases

SBROILGP1KF

Case for Brother printer



Watch our KlickFast carrying demo at peterjonesilg.co.uk/klickfast

HANDCUFF HOLDERS



P200

Our innovative design, made from high quality leather and durable moulded nylon, offers more than other similar holders on the market. The Peter Jones Design Department has produced a moulding to sit inside our latest Speedcuff holder. This moulding is shaped to hold the cuffs in position once the retaining strap is released for use. This standard P200 product also has the bonus of our ratchet belt loop mechanism, which can be adjusted for comfort.

P200MV

As the P200, but fitted with a ratchet mechanism suitable for use on a MOLLE Vest.



P108

Fully enclosed handcuff pouch



P109

Soft leather handcuff case with belt attachment

P142

Open top firm leather handcuff case with belt attachment

P143

Leather handcuff strap with belt attachment

P181

Open top leather case for larger handcuffs with ratchet fitting and 50mm (2") belt loop 95 x 150 x 38mm (3.75" x 6" x 1.5")

P181A

As above but with 38mm (1.5") belt loop

P181B

As P181A but with non-ratchet belt loop



Quick and easy draw



P200KF

As the P200, but fitted with our Klick Fast Carrying System stud and dock.



KlickFast, a combined quick-release and ratchet mechanism for use on belts and garments, see page 10 for details.

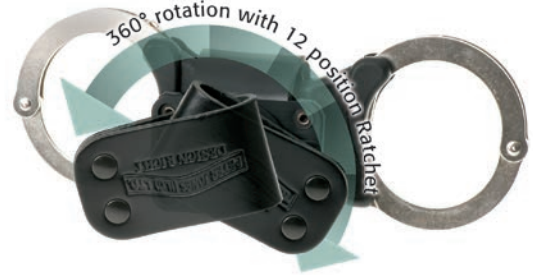

P200 FIXED BL

As the P200 except the belt loop is in a fixed position, with no ratchet mechanism.

P151CR

Handcuff pouch with centrally mounted click stopped belt loop

P151TR

Handcuff pouch with top mounted click stopped belt loop



BENEFIT FROM SECURITY-COMFORT-SPEED

- ✓ Security of pouch and retaining strap
- ✓ Adjustable 360° ratchet for preferred action
- ✓ Alternative KlickFast quick release/ratchet system
- ✓ Ease and speed of withdrawal and relocation
- ✓ Body protection from metal parts
- ✓ Choice of high or low carriage

Find out more at peterjonesilg.co.uk/p200

Garment Mounting

Camera KlickFast Tilt Stud

This KlickFast Stud provides a tilt only mechanism which allows the camera to be repositioned in place. Custom mounting plates are available to integrate with most brands of body-worn camera.



Body-worn Camera Mountings

Camera KlickFast Swivel Stud

The swivel mechanism of this KlickFast Stud allows the camera to be repositioned in place to any angle. Available to special order, subject to quantity.



P200 KF

The KlickFast Stud allows quick release from your garment, whilst the moulding inside our innovative Speedcuff holder is shaped to hold the cuffs in position once the retaining strap is released for use.

P175 KF

Designed and developed with the assistance of operational and training personnel, the P175 range of spray holders addresses the failures and difficulties experienced with conventional pouches.



DOCK08

Screw on through garment.



DOCKRSMTAG

Converts existing remote speaker mic tags on specialist uniforms to the KlickFast system.



DOCK06

Stitch on to garment. Allows a wide range of equipment to be attached and repositioned in place.

DOCK06 EVO2

Incorporates a lanyard attachment point.



RSTUD BELT CLIP

This KlickFast Stud integrates with Peli LED torches. The backplate is reversible to allow use with the thicker clips on torches made by some other manufacturers.





TETRA Airwave Radios

Cases are available for a wide range of radios.



RSTP8000ILGP2 KF

Suitable for the Sepura STP8000 radio.



RSTUDKFTORCH

The KlickFast Stud is adjustable to fit torches from 20 to 30mm in diameter. Also suitable for cameras of similar shape.



P174LSKF

Expandable Baton Holder

Still room to add additional equipment...

Mobile Data Devices

We have a range of cases for PDAs and Printers.



SBBERRYZ30 KFNOD

Case for Blackberry Z30

Taser X26 Exo Skeleton KlickFast Stud

This custom KlickFast Stud integrates with the X26 Exo Skeleton Taser Holder and is mounted using the existing nuts and bolts that are fitted to the holder. A choice of two orientations enables left- or right-handed draw according to preference.



P198AX26 EXO

P198BX26 EXO

Docks

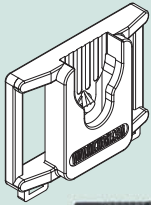

Belt Docks
 to suit 32mm belt
 to suit 38mm belt
 to suit 50mm belt
 to suit 60mm belt

DOCK01
DOCK02
DOCK03
DOCK07



Available in four sizes to suit all widths of belt.

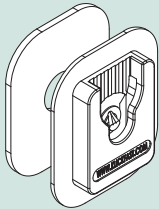

Stick-on Dock DOCK04
 Same fitting as Sew-on Dock but with a self adhesive backing for mounting on vehicle dashboards and walls.

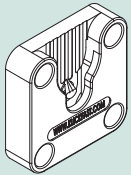

Screw-on Dock DOCK05
 Four recessed mounting holes allow the Screw-on Dock to be securely mounted almost anywhere.



Sew-on Dock DOCK06 / EVO2
 A nylon dock for stitching onto uniforms or protective clothing, wherever they are most comfortable. DOCK06 EVO2 includes a lanyard attachment point.

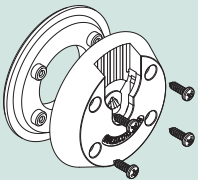

'Screw-to-Fit' Dock DOCK08
 Awaiting garments with sewn on docks? Upgrade your existing garments in minutes with this dock.

Klick Fast System Dock to Lock, Click to Stick

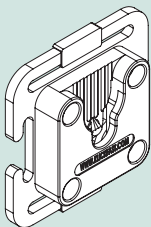

Harness Mount Dock
 Enables attachment of equipment to a harness strap. Two 'keepers' click securely into place to allow the Dock to be configured for two sizes of strap.

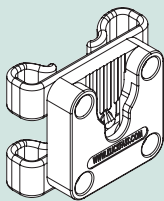

Rucksack Mount Dock
 Enables attachment of equipment to a rucksack strap. Simply clips onto the padded straps in your chosen position.

Handlebar Dock DOCKHBARMOUNT

Mount for bicycle handlebars.

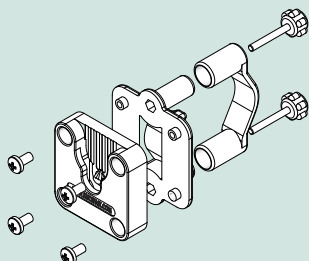

Klick Fast Carrying System Innovative Solutions



DOCKEPAULETTE

Designed to hang from epaulette.



DOCK04
 Stick-on Dock



DOCK08
 Screw-to-Fit Dock



DOCK05 BC
 Easy mounting for trousers and skirts when no belt is worn, by use of the leather covered sprung belt clip, with the DOCK on the outside.



DOCKMV
 MOLLE System Dock



DOCKHELMET
 To fit a Picatinny rail



* Subject to quantity



DOCKHBARMOUNT
 Handlebar mounting Dock



Watch our Klick Fast demonstration

DOCKCLAMP

The latest DOCK that clamps into Garment Tags, Shirt Pockets, Jacket Zip openings and Skirts, with a counter balance block to stop the device tilting forward.



DOCK07
60mm Belt Dock



DOCK01
32mm Belt Dock



DOCK05
Screw-on Dock



DOCK06
Sew-on Dock



DOCKRSMTAG
RSM Dock



RBELTCLIPKFKIT

Converts case with a Click Fast connector to a belt clip fitting.

RSTUDFBLKIT

Converts case with belt loop to Click Fast operation.



DOCKHARNESS



DOCKRUCKSACK

Harnesses

These Harnesses suit any Klick Fast case (not included).



SSHLDER3KF
Under Arm Holster

A slim, extremely comfortable leather harness which allows a radio case to be docked out of sight under a jacket. The under arm holster is fully adjustable, with leather and elastic straps.



SSHLDER4KF
Centre Chest Harness

This harness mounts the radio in the centre of the chest using a KlickFast Mounting Dock and incorporates nylon straps that slip over the arms and shoulders.



SSHLDER14M
Radio Utility Harness

Fits 50mm Belt.
(Also available to fit 60mm Belt, add **D07** to part number.)

Attaches to a Utility Belt via two KlickFast Docks and a loop. Allows radio mounting on either side via Docks attached to the adjustable down straps.



SSHLDER15
Sam Browne Harness

Fits 50mm Belt.
(Also available to fit 60mm Belt, add **D07** to part number.)

Attaches to the Utility Belt front and rear via two KlickFast Docks and incorporates a nylon shoulder strap with Sam Browne chest mounting Dock.



SSHLDER999ADJKF
Chest Harness

This harness mounts the radio on the chest using a KlickFast Mounting Dock. The radio mounting position is fully adjustable.

Please Note: Fitting any product not manufactured by Peter Jones (ILG) Ltd into a KlickFast fitting or onto a KlickFast stud will invalidate your warranty.
"The Manufacturer hereby excludes all liability for any loss caused by the failure of any equipment manufactured by a third party (including but not limited to protective equipment) to perform in accordance with its specification where the product is attached to or used in conjunction with such equipment other than in accordance with the manufacturer's instructions."

BELTS and ACCESSORIES



P165
Resuscitator pack, with face shield, disposable gloves and antiseptic wipe.



P121
Leather pouch for latex gloves and face mask. 100 x 75mm (4" x 3")



P141
Black leather pouch. 76 x 121mm (3" x 4.75")



P134
Torch belt hanger, D series 44mm (1.75") diameter.

P135
Torch belt hanger, C series 38mm (1.5") diameter.

P194C

Torch hanger for C series maglites, with belt loop.

P194D

Torch hanger for D series maglites, with belt loop.



SKEY 01

Credit card key ring.



P133
Mini maglite holder, with belt loop.

P118

Two pen holder, with belt loop.



P144 BL

Five pen holder, can be worn on a belt or in a shirt pocket. 127 x 114mm (5" x 4.5")



P149 L/R

Soft leather pocket protector, for left or right hand pocket.



P176

Leather pouch for resuscitator pack, with belt loop. 57 x 89mm (2.25" x 3.5")



P159

Key pouch with internal D-ring. 160 x 100mm (6.25" x 4")



P120

Key pouch. 150 x 100mm (6" x 4"). Other sizes available.



P123

Belt fitting with lanyard



P157

Key pouch with internal D-ring and double ring closure for padlock fastening. 125 x 89mm (5" x 3.5")

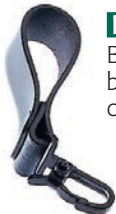

P147B
Black coated belt trigger clip.



BELTKEYMOUNT

Belt fitting Key Mount with lanyard

P137
Whistle.



P130
Belt spring clip.



RECTBC

Retractable key chain, chrome plated with belt clip.



P124

Warden's key chain, 890mm (32") with chrome welded-link chain, swivel spring clip and leather belt loop.



PWC001

Whistle Chain.

CLPPSO

Key chain hook.





P189A
7" (178mm) heavy duty leather belt spacer for improved weight distribution and comfort

P189APS
As above but with press studs

P189B
9" (229mm) heavy duty spacer

P189BPS
As above but with press studs



NYSTR 49
50mm (2") black nylon webbing belt, fully adjustable with quick release buckle.

NYSTR 8
As above 38mm (1.5").



P177
Belt retaining loop, with pouch to store handcuff key.



P177A
Belt keepers, set of three



NYSTR 116
Black nylon anti-strangle lanyard with quick release clasps. Removable segments allow adjustable length.



LBTLT 1
32mm (1.25 inch) leather belt with nickel plated buckle Available in two sizes.

PLBBB 32
As above with black buckle.



LTBLT 8 S/M/L
50mm (2") stout leather belt with double pronged nickel plated buckle.



LTBLT11 S/M/L
Utility belt, velcro lined, quick release buckle

POUCHES and WALLETS

P145
Soft leather glasses pouch. 165 x 89 x 38mm (6.5" x 3.5" x 1.5")

P145 DIS
Dispersal pouch for notebooks etc, compartmented with press studded belt loop. 165 x 89 x 32mm (6.5" x 3.5" x 1.25")



P119
Leather pouch, with belt attachment suitable for wallets and notebooks. 178 x 114 x 38mm (7" x 4.5" x 1.5")

P114L
Firm, up and over style, leather bookcover 165 x 114mm (6.5" x 4.5") to take book 152 x 102mm (6" x 4")

P114S
to take book 140 x 89mm (5.5" x 3.5").

P112
Soft leather book cover 165 x 114mm (6.5" x 4.5") to take book 152 x 102mm (6" x 4").



P167
Leather card wallet, with twelve PVC pockets. 83 x 57mm (3.25" x 2.25")



P113
Soft, book style, leather bookcover 165 x 114mm (6.5" x 4.5") to take book 152 x 102mm (6" x 4").



P117
Leather ID wallet, to take card 83 x 57mm (3.25" x 2.25").

Can be worn with flap A out of the top pocket.

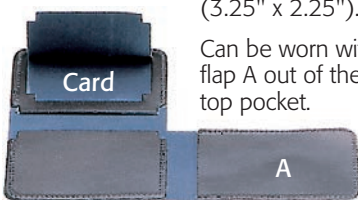

P163
Document wallet suitable for most police issue pads and other documents.

Features one external and four internal pockets, with rigid cover to assist writing. 152 x 178mm (6" x 7") when closed.



P115
Small warrant card holder, with two PVC pockets. 83 x 50mm (3.25" x 2")



P127
Fixed penalty fine wallet for documents. 349 x 114mm (13.75" x 4.5") when open



EXPANDABLE BATON HOLDER

P174

Made from high quality leather and durable moulded nylon, the P174 range of holders ensure **SECURITY-COMFORT-SERVICE** when complementing expandable batons

P174ASPTALON 50
P174ASPTALON 60



Adjustable for left/right handed use

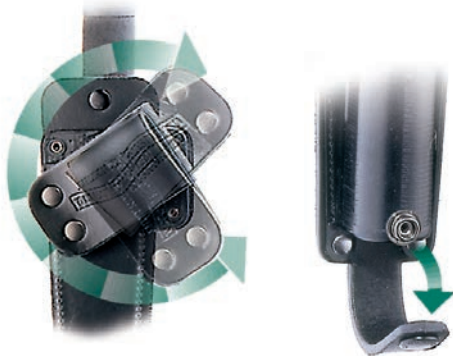

360° ratchet belt loop



P174FCN



P174LS



P174LSMV
For MOLLE Vest

BENEFIT FROM INNOVATIVE DESIGN

- ✓ Secure 360° adjustable carriage
- ✓ Right/left hand thumb release
- ✓ Ease and speed of withdrawal/relocation
- ✓ Permits carriage in expanded mode
- ✓ Prevention of accidental/involuntary expansion
- ✓ Belt, harness, garment attachment options
- ✓ Compatible with friction-lock or autolock batons



P174A
Fixed horizontal



P174LKNBS

Find out more at peterjonesilg.co.uk/p174

SIDE HANDLE BATON HOLDER

P162

Made from high quality leather and durable moulded nylon, the P162 range of holders ensure **SECURITY-COMFORT-SERVICE** when complementing side handle batons

P174B



P162



P162
P162D
P162C
P162DL

For fixed or expanding batons



P162S

For straight rigid batons



P174LSKF
P174LKKF

ClickFast carriage system



ClickFast, a combined quick-release and ratchet mechanism for use on belts and garments, see page 10 for details



Compatible batons

KEY TO COMPATIBLE EQUIPMENT

Product Reference	Canister Diameter	Belt Size
P175	35mm	Ratcheted 50mm (2") belt loop
P175 AR (right handed)	35mm	Fixed position 50-55mm (2-2.25") belt loop
P175 AL (left handed)	35mm	Fixed position 50-55mm (2-2.25") belt loop
P175 MV	35mm	N/A
P175 SEW	35mm	N/A
P175 SEW38	38mm	N/A
P175 38 CN	38mm	Ratcheted 55mm (2.25") belt loop
P175 38 S	38mm	Ratcheted 50mm (2") belt loop
P175 KF	35mm	Choice of other Klick Fast Docks available
P175 C	35mm	Motor cycle boot fitting (clip)
P175 CSTR	35mm	Motor cycle boot fitting (strap)

Nearly all our items can be fitted with a 50 or 55mm belt loop and a 35 or 38mm canister

Product Reference	Baton Type	Belt Size
P174 LS	540mm (21") friction lock A, C, M	Ratcheted 50mm (2") belt loop
P174 A	540mm (21") friction lock A, C, M	Fixed horizontal 35mm (1.25") belt loop
P174 ASPTALON50	500mm (19.5") button release AT	Ratcheted 50mm (2") belt loop
P174 ASPTALON50CN	500mm (19.5") button release AT	Ratcheted 55mm (2.25") belt loop
P174 ASPTALON60	600mm (23.5") button release AT	Ratcheted 50mm (2") belt loop
P174 ASPTALON60CN	600mm (23.5") button release AT	Ratcheted 55mm (2.25") belt loop
P174 B	650mm (26") friction lock A, C, M	Ratcheted 50mm (2") belt loop
P174 BX	MX range trigger lock M	Ratcheted 50mm (2") belt loop
P174 LSCN	540mm (21") friction lock A, C, M	Ratcheted 55mm (2.25") belt loop
P174 BCN	650mm (26") friction lock A, C, M	Ratcheted 55 mm (2.25") belt loop
P174 LK	540mm (21") autolock M	Ratcheted 50mm (2") belt loop
P174 BLK	650mm (26") autolock M	Ratcheted 50mm (2") belt loop
P174 LKCN	540mm (21") autolock M	Ratcheted 55 mm (2.25") belt loop
P174 BLKCN	650mm (26") autolock M	Ratcheted 55 mm (2.25") belt loop
P174 TLK	540mm (21") autolock M	Ratcheted 35 mm (1.25") belt loop
P174 LSKF	540mm (21") friction lock A, C, M	Choice of Klick Fast Docks
P174 BKF	650mm (26") friction lock A, C, M	Choice of Klick Fast Docks
P174 LKKF	540mm (21") autolock M	Choice of Klick Fast Docks
P174 TLKKF	540mm (21") autolock M	Choice of Klick Fast Docks
P174 F-CN	506mm (19.75") autolock baton B	Ratcheted 55mm (2.25") belt loop
P174 D	400mm (15.75") friction lock baton A	Ratcheted 50mm (2") belt loop
P174 HGFG	540mm (21") autolock M	Ratcheted 50mm (2") belt loop
P174 HGFGCN	540mm (21") autolock M	Ratcheted 55mm (2.25") belt loop
P162	Rigid/Expandable Side Handle M	Ratcheted 50mm (2") belt loop
P162 C	Rigid/Expandable Side Handle M	Low carriage 50mm (2") belt loop
P162 D	Control Device M	Ratcheted 50mm (2") belt loop
P162 DL	Control Device M	Low carriage 50mm (2") belt loop
P162 S	For a straight baton AR	Ratcheted 50mm (2") belt loop

A ASP • **AR** ARNOLD • **AT** ASP TALON • **B** BONOWI • **C** CASCO • **M** MONADNOCK



For further information please ask for copies of our other brochures. Seen here are our 'TETRA Radio Equipment' and 'Mobile Data' brochures